

7a The Street - £1,150 PCM

Beck Row Suffolk IP28 8AD

shires

Estate & Letting Agents



"Consistently providing outstanding service to our clients"

£1,150 PCM

The Property

This modern three bedroom semi-detached house is located in the village of Beck Row. The property has an open plan living area and is modern throughout, property is available now and ready to view!

Features

- SEMI DETACHED HOUSE
- CLOSE TO RAF BASES
- 3 BEDROOMS
- OIL HEATING & ENERGY RATING - D
- LARGE KITCHEN
- APPROXIMATE SIZE - 721 SQ FT
- FAMILY BATHROOM & CLOAKROOM
- COUNCIL TAX BAND - B
- PARKING & GARDEN
- AVAILABLE NOW





These sales particulars have been produced as a general guide only and we would draw to your attention that we have not carried out a detailed Survey of the property nor have we tested services, appliances or specific fittings. Whilst measurements and statements given within the details are provided in good faith, their accuracy should not be relied upon. If there are any points about which you may be uncertain or would like further clarification, we would suggest that you telephone this office and speak to our staff who will endeavour to assist you.

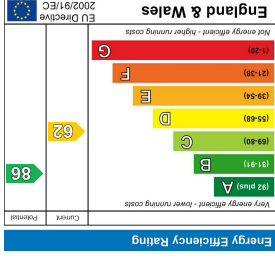

Whilst every attempt has been made to ensure the accuracy of the floor plan contained here, measurements of doors, windows, rooms and any other items are approximate and no responsibility is taken for any error, omission, or mis-statement. This plan is for illustrative purposes only and should be used as such by any prospective purchaser. The services, systems and appliances shown have not been tested and no guarantee as to their operability or efficiency can be given.

TOTAL APPROX. FLOOR AREA 711 SQ.FT. (66.0 SQ.M.)
 1ST FLOOR APPROX. FLOOR AREA 349 SQ.FT. (32.5 SQ.M.)
 GROUND FLOOR APPROX. FLOOR AREA 361 SQ.FT. (33.6 SQ.M.)

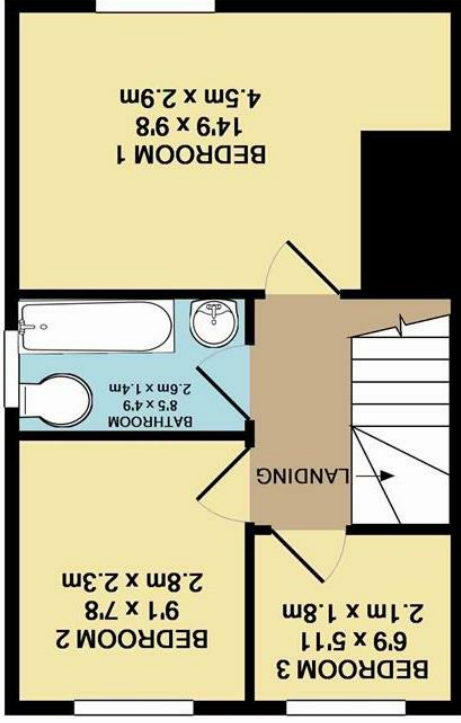
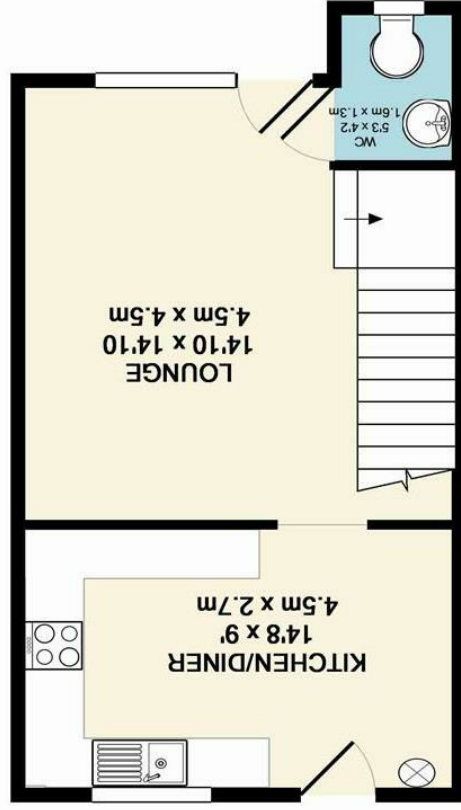

4 New Street, Mildenhall, Suffolk, IP28 7EN
 T: 01638 712132
 E: mildenhall@shiresestateagents.co.uk